

Twice as good!



autop Maestro 2.32

The autop Maestro 2.32 is a 2-motor, electro-mechanical 2-post lift for repair and maintenance, with a lifting capacity of 3.2 t.

Maestro 2.32 has been developed especially to offer high flexibility and optimized lifting capacity for workshops serving city cars, private cars and small transporters.

Maestro 2.32 is available with either flex pads or the new Combiflex CF-08 pads. We offer a large program of both U-shaped and flex pads.



autop Maschinenbau GmbH

Sandkampstr. 90

D-48432 Rheine

Tel. ++49(0)5971/8602-02

Fax ++49(0)5971/8602-25

E-Mail: mail@autop.de

www.autop.de

...a company of the STENHØJ-group!

Professional lifting technology!

Maestro 2.32

Components

- spindle, cold-rolled, centered, long working life
- Lifting mechanism: 6 large guiding wheels in lubrication-free needle bearings
- Nut set: highest quality due to special synthetic alloy
- Safety system:
 - nut breakage system
 - internal arm locking system
 - control unit with dead-man controls and separate main switch
- swivel arms: can be parallel-parked, especially for vehicles with a short wheel base

Standard colour:

Posts: RAL 9002 (white)

Arms: RAL 7016 (grey anthracite)

Modell	A	B	C	D	E	F	G	H	I	J	K
F	3240-3440	2380-2580	2960-3160	3120-3320	4050/4350	2713	1900	2020	2120-2320	550	465
CF-08	3240-3440	2380-2580	2960-3160	3120-3320	4050/4350	2713	1900	2030	2120-2320	550	465

Modell	L	M	N	O	P	Q	R	S	T	U	V
F	∅120	540	850	900	1425	95	115	85	100	190	260
CF-08	∅120	555	840	920	1415	92	250	95	100	190	

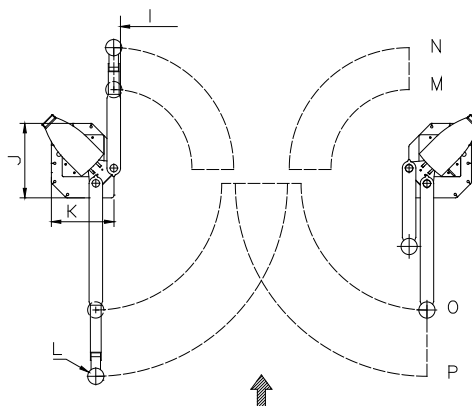
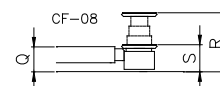
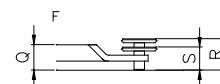
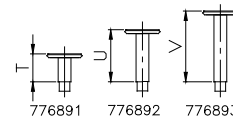
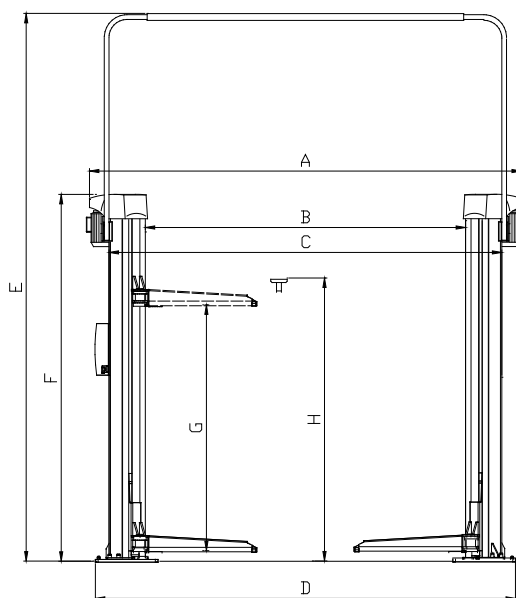

Technical data:

Capacity:	3,200	kg
Lifting/lowering time:	appr. 40	sec.
Voltage:	230/400	V
	50	HZ
Motors:	2 x 1.5	kW



No liability accepted for specifications that are subject to alteration - validity 1.0/2011. The date and pictures in this product information are not binding and are only giving an approximate description. Moreover we reserve the right of differences between the goods delivered and the date and pictures given here (i.e. technical data, equipment, material and optical appearance) so far as the differences are reasonable for the customer and a possible reduction in value of the goods delivered is not considerable.

autop Maschinenbau GmbH

Sandkampstr. 90

D-48432 Rheine

Tel. ++49(0)5971/8602-02

Fax ++49(0)5971/8602-25

E-Mail: mail@autop.de

www.autop.de

...a company of the STENHØJ-group!

Service:

Our expert consultants would appreciate to help you with the planning of a new garage or the modernization of an existing one. We offer to work out a workshop concept incl. an equipment proposal.

Please do not hesitate to contact us!

